

# NASH NEWS



Newsletter - August 2021

## HIGHLIGHTS

CHAIRMAN'S REFLECTIONS - PAGE 1

NASH PUBLICATIONS & RESOURCES - PAGE 1

NASH UPDATE - PAGE 2

- INTRODUCING THE NASH BOARD
- BUILDING CODE CHANGES
- THERE IS NO TIMBER FIRST- POLICY
- SKILLS SHIFT INITIATIVE

GETTING TO KNOW NASH MEMBERS - ROLLFORMING SERVICES - PAGE 3

## CONTACT US

NATIONAL ASSOCIATION OF STEEL FRAMED HOUSING

P.O. BOX 76134  
MANUKAU

PHONE: 09 262 4846

EMAIL:  
GM@NASHNZ.ORG.NZ OR  
CHERIE@NASHNZ.ORG.NZ

 WWW.NASHNZ.ORG.NZ

 NASH FACEBOOK

## CHAIRMAN'S REFLECTIONS

It has been a busy couple of months for both the NASH team, (as you will see from the Newsletter) and our sector.

Supply issues (with that other residential framing material) have resulted in a significant increase in inquiries and new opportunities for our fabricators. NASH members need to seize the opportunity with care.

Firstly, past experience from other boom times has taught us that some new prospects may have been declined supply for reasons other than material shortage – so please do your due diligence before fabricating.

Secondly an influx of new customers unfamiliar with light steel frame will need more on site support from our fabricators during those first three or so houses when sub trades become familiar with light steel frame.

NASH held its AGM in June which included presentations from the NASH team on our recently completed R &D Scoping exercise (funded by BRANZ), progress on skills training with Building & Construction Industry Training Organisation (detailing) and polytechs.

Pouya Lofti Rad also gave a presentation on his doctorate research into Seismic Bracing Solutions.

Rodney Stokes from EQSTRUC presented the quick calculators for Light Steel Frame Joists and Beams, which he and the team at EQSTRUC have developed for Light Gauge Steel structures.

Gary Knofflock

## NASH PUBLICATIONS & RESOURCES

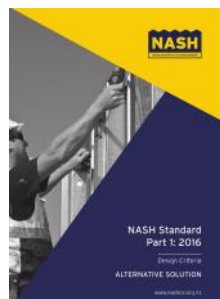

Did you know that there are a number of publications and resources available on the NASH website. To view what resources are available **See more**

With NASH Standard for Residential and Low-rise Steel Framing Part 1, NASH Standard Part 2: 2019 and NASH Building Envelope Solutions 2019 available free to download. **See more**

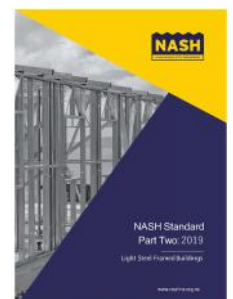

NASH WISHES TO ACKNOWLEDGE THE SUPPORT OF NEW ZEALAND STEEL



## NASH UPDATE

### INTRODUCING THE NASH BOARD FOR 2021/2022

Thank you to those NASH members that are supporting NASH by sitting on the Board.

Gary Knofflock - Silverframes - Chairman

Dan Spencer - Framecad - Deputy Chairman

Bhaskar Sharma - Alrite Steel & Services

Mark Armstrong - Rollforming Services

Steven Cook - Steelhaus 2014 Ltd

Sidhant Kumar - Redco

Paul Jenkins - New Zealand Steel

Lance Curry - Scottsdale Construction System

Dr Kawa Andisheh - HERA

Jamie Hodgesson - CH Engineering

Vicki Rose - Steelrite

Dan Blackbourn - Steel & Tube

### BUILDING CODE CHANGES DRIVES WARMER, DRIER, ENVIRONMENTALLY FRIENDLY HOMES

Every year MBIE consults on the Building Code. This year's proposed changes aim to make homes and buildings warmer, drier and healthier, with less impact on our environment, while also bringing New Zealand more in line with international standards.

Metals New Zealand in partnership with the National Association of Steel Framed Housing Inc (NASH) has submitted on the proposed changes, which are long overdue. Read our submission here

**Metals New Zealand NASH submission-form-building-code-consultation-2021 final.**

**Read more**

### THERE IS NO TIMBER FIRST POLICY

***"There is no 'timber-first' policy. There is a policy to reduce the carbon impact of government buildings."***

This is Minister for Economic Development, Government Procurement and Forestry Hon. Stuart Nash's response to **written parliamentary questions from Opposition spokesperson for Construction Tim van de Molen**, inquiring into the government's timber-first policy in June 2021.

The minister and his predecessor have been subjected to significant lobbying by sector players to adopt a timber-first policy for the procurement of government buildings. The minister was right not to yield to pressure.

In a comment piece which ran in the **National Business Review** on 17 July, Metals outlines why Nash was right to reject a 'wood-first' policy.

This includes the fact that New Zealand's Building Code and government procurement are material agnostic, focused on delivering resilient and high-performing buildings. Decisions with respect to which material is used in what building needs to be left to architects and engineers based on independent robust data, informed by International Standards and New Zealand's specific seismic/climatic challenges.

Read the full comment piece here as a PDF:**NBR-No timber first policy-17.07.21** or online at the **National Business Review**.

**Source NBR / Metals New Zealand. Author: Nick Collins**

### SKILLS SHIFT INITIATIVE

The Manufacturers Network, led by Dieter Adam has been leading a Skills Shift Initiative, which has ultimately resulted in the development of a vocational training unit, targeting (mostly older) workers in manufacturing operations who are / will be struggling to keep up with the increased use of digital technologies in their workplace.

The unit is now recognised by the Tertiary Education Commission, TEC, as a micro-credential, meaning the delivery will be financially supported by the TEC through Competenz.

The video clip provides a short introduction, based on the pilot implementation of the unit at Buckley Systems in Auckland. <https://www.competenz.org.nz/digital-skills-manufacturing/>

#### HOW IS IT DELIVERED?

This programme is best delivered via a training provider and is fully funded under the Government's Targeted Training and Apprenticeship Fund (TTAF). Employers don't have to pay anything for this micro-credential if they enroll before December 31 2022.

Elaine McQueen, who project managed the development of the unit, is available to answer your questions, or those of your members, and help you to access the delivery of the training, and can be reached on 022-089 1841.



**NASH WISHES TO ACKNOWLEDGE THE SUPPORT OF ALRITE STEEL & SERVICES NZ LTD WITH THE NASH SEISMIC BRACING R & D PROGRAMME**



## Getting to know our NASH members -ROLLFORMING SERVICES



### Interior in-fill framing that always measures up

Anyone who has done any work in retrofit framing will know that internal structures on existing premises are almost never square.

For traditional timber framing (and even for steel stud and track and panelised solutions) that causes a major headache. You need highly accurate measurements of every length, the calculation of complex angles, then cutting (and often re-cutting) of framing components; all done on-site. This requires a skilled crew and it takes time. Lots of time. Multiply that by several hourly rates and you have a scenario you do not need.



### Step up to the stage, telescopic framing for interior and retrofit spaces.



Rollforming Services are producing telescopic steel framing that takes away that headache. These panels expand vertically and horizontally on each side, making leveling up a breeze. No re-cutting or re-sizing, the job is done in minutes rather than hours. The panels are strong,

lightweight, and retractable, so they are easy to move around on-site, even in tight spaces.

Rollforming Services manufacture these frames off-site using a Howick X-TENDA 3600 machine. They are pre-assembled, compressed for easy transport and can be quickly expanded and adjusted on site for a perfect fit every time. It is simple and highly accurate.

If you want to see just how easy they are to use, [check out this video](#)

### Game changer.



Faster assembly, less wastage, less labour - this off-site light steel technology is transforming how retrofit jobs are carried out. Already it is becoming the go-to option for new build and refurbishment contractors.

Rollforming Services recently secured an order for 75,000 metres of telescopic studs for a Wellington multi-storey new build, with another pending order for a large refurbishment project in Auckland.

Would you like to know more? [Get in touch](#) with Rollforming Services now.

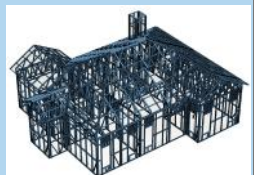

## NASH R & D UPDATE

In June, Dan Spence, Bruce Campbell and Alistair Fleming gave the Light Steel Framing presentation to Architectural Technology and Quantity Surveying students at Wintec in Hamilton. The content is part of their course relating to construction materials. As always great questions from the students, even the lecturer indicated he learned more about steel framing.

BRANZ are progressing with the e-learning modules, we should see the next version soon.

NASH WISHES TO ACKNOWLEDGE THE SUPPORT OF EQSTRUC WHO HAVE DEVELOPED JOIST AND BEAM CALCULATORS FOR LIGHT GAUGE STEEL, REFER

[WWW.EQSTRUC.CO.NZ/CALCULATOR-LIGHT-GAUGE-STEEL-LGS-JOISTS/](http://WWW.EQSTRUC.CO.NZ/CALCULATOR-LIGHT-GAUGE-STEEL-LGS-JOISTS/)

